



76 Gittoes Lane Possum Creek NSW

2 1 12

This charming property nestled down a quiet country lane in the beautiful Possum Creek area is bound to delight.

With the original timber cutters cottage dating back to 1886, using timber milled on the property, it is like going back in time.

Local hardwood timber lines the floors and walls, beautifully kept by the current owners, it holds the history of the region.

The house has 2 main bedrooms plus a sleep out, open plan living and a generous kitchen, as well as air-conditioning and a wood fire feature.

This secluded sanctuary is perfect as a retreat away from it

Type : House
Land Size : 184213 sqm
View : <https://www.fullerandco.com.au/8292486>



Gail Fuller Jp
02 5642 0177



Scot Fuller
02 5642 0177

[For full version visit the website](https://www.fullerandco.com.au)



GROUND FLOOR

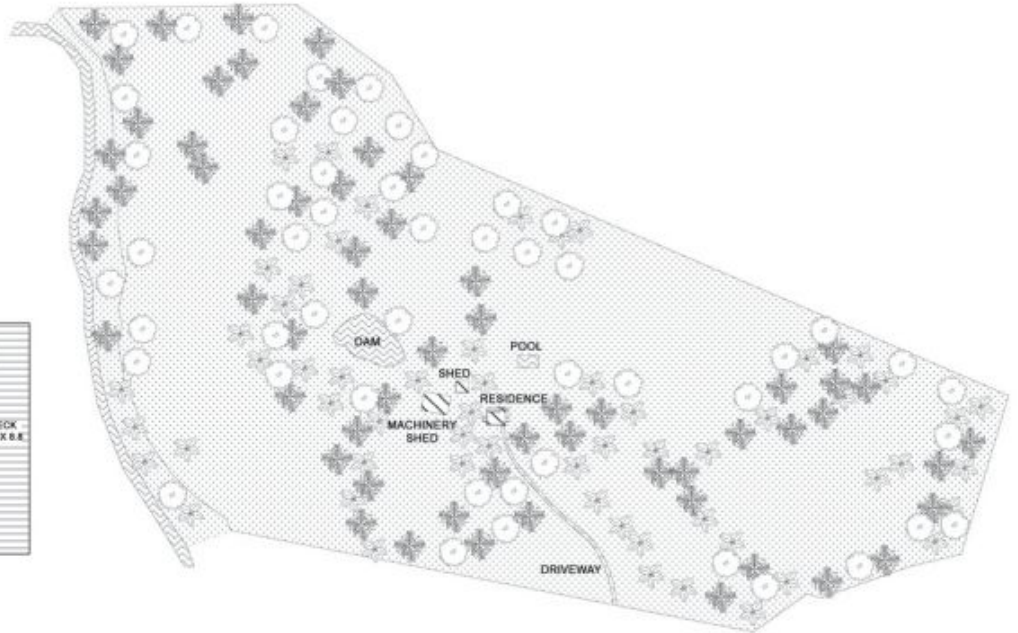

SITE PLAN
(NOT TO SCALE)

76 GITTOES LANE

POSSUM CREEK

Floor Plan Disclaimer: Mable Drive (MD) floor plans / site plans are intended as an approximate guide only. No representations or warranties of any nature are given or intended and any person using this information other than as a guide should always rely on their own enquiries. Mable Drive property marketing services / 0413075054 / Photography: Floor plans, Videos, Aerial photography / www.mabledrive.com.au



APPROXIMATE AREAS

INTERNAL FLOOR SPACE - 100m²

EXTERNAL FLOOR SPACE - 47m²