



## 11 Campbell Street Bangalow NSW

3 2 2

### The Know:

This is what you have been waiting for. Properties in this calibre and this location are next to none.

Located within a two minute stroll to the heart of Bangalow this property has been tastefully built in capturing breath taking hinterland views

The home is set over 3 levels with the main entry hall leading into the downstairs large entertaining room with gas fireplace and includes a built in queen bed. This is the perfect space for visiting family and friends.

The main living level has a modern spacious kitchen with

[For full version visit the website](https://www.fullerandco.com.au/8292500)

**Type** : House  
**Land Size** : 417 sqm  
**View** : <https://www.fullerandco.com.au/8292500>



**Scot Fuller**  
02 5642 0177

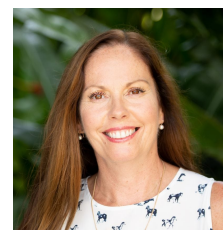

**Gail Fuller Jp**  
02 5642 0177



FIRST FLOOR

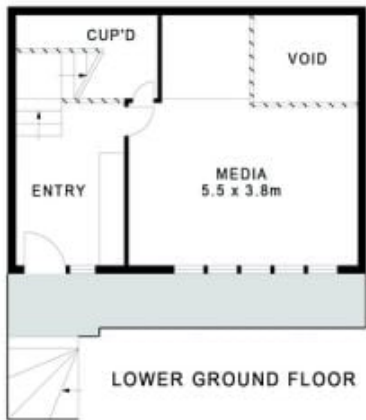

LOWER GROUND FLOOR



GROUND FLOOR



SITE PLAN  
(NOT TO SCALE)



FULLER  
& CO

11 CAMPBELL STREET

BANGALOW

Floor Plan Disclaimer: Media Drive floor plans / site plans are intended as an approximate guide only. No representations or warranties of any nature are given or intended and any person using this information other than as a guide should always rely on their own enquiries Media Drive property marketing services. / Photography: Floor plans, Video, Aerial photography / https://Media Drive.com.au



APPROXIMATE AREAS

INTERNAL FLOOR SPACE - 162m<sup>2</sup>

EXTERNAL FLOOR SPACE - 22m<sup>2</sup>