



4 Coachwood Close Byron Bay NSW

4 2 4

This great family home is situated in the Sunrise Beach estate in a quiet location close to parkland.

The spacious living areas overlook the garden and are light filled with extra windows. Adjacent to the kitchen is the dining and additional living space which opens onto the garden and wonderful covered outdoor entertaining deck. The deck, pool and gardens have lighting featured for a beautiful ambiance at night.

The home has 4 bedrooms, with the main hosting an en-suite bathroom.

The main bedroom is separate to the other three so offering privacy and a parents retreat if needed.

Type : House

Land Size : 720 sqm

View : <https://www.fullerandco.com.au/8292510>



Gail Fuller Jp
02 5642 0177



Scot Fuller
02 5642 0177

[For full version visit the website](https://www.fullerandco.com.au)

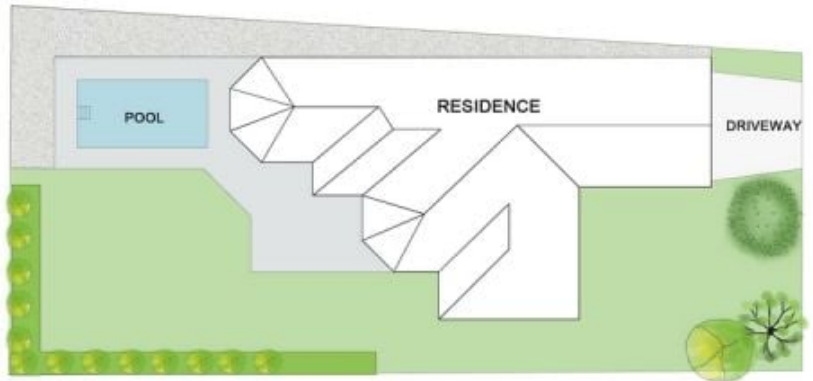

SITE PLAN
(NOT TO SCALE)

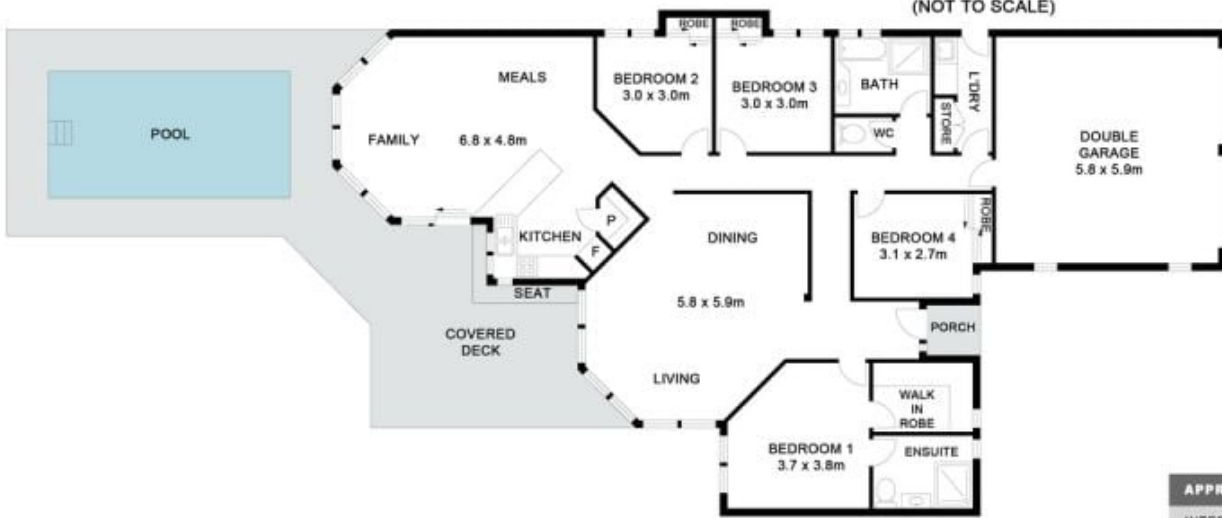

4 Coachwood Cl, Byron Bay

Floor Plan Disclaimer: See the Studio floor plans / site plans are intended as an approximate guide only. No representations or warranties of any nature are given or intended and any person using this information other than as a guide should always rely on their own enquiries. See the Studio property marketing services / Photography. Floor plans, Video, Aerial photography | <https://beelivesolutions.com.au>



| APPROXIMATE AREAS | |
|----------------------|---------------------|
| INTERNAL FLOOR SPACE | - 199m ² |
| EXTERNAL FLOOR SPACE | - 78m ² |
| CARPORIT | - 34m ² |