



145 Parkway Drive Ewingsdale NSW

4 🏠 3 🚗 6 🚗

This exclusive home is set amongst beautiful established gardens located in Ewingsdale, just minutes from Byron's hustle and bustle.

The property is set on 4750m² of lush land private land, with access to Simpson creek.

The interior is complimented with plenty of warm wooden accents making for the perfect space to call home. The stunning 20ft plus ceilings provide an abundance of natural light. The living-dining and kitchen are of an open plan concept. Original beams from the Norco factory feature in the main living.

Type : House
Land Size : 4750 sqm
View : <https://www.fullerandco.com.au/8292512>



Scot Fuller
02 5642 0177



Gail Fuller Jp
02 5642 0177

[For full version visit the website](#)

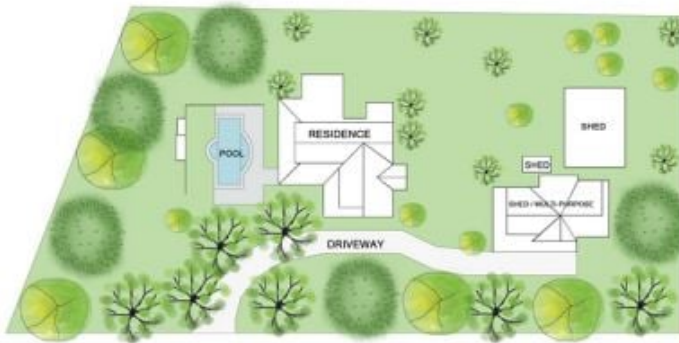

SITE PLAN (NOT TO SCALE)



145 PARKWAY DRIVE

EWINGSDALE

Floor Plan Disclaimer: See How Studios floor plans / site plans are intended as an approximate guide only. No representations or warranties of any nature are given or intended and any person using this information other than as a guide should always rely on their own enquiries. See How Studios property marketing services / Photography. Floor plans, Video, Aerial photography / <https://howstudios.com.au>



4



4



3

APPROXIMATE AREAS	
INTERNAL FLOOR SPACE	- 449m ²
EXTERNAL FLOOR SPACE	- 217m ²
CARPORT	- 41m ²