



### 3 Botanic Court Mullumbimby NSW

3  1  2 

Located in a prime position just a few minutes walk from the local showgrounds and farmers market and 2km to the Mullumbimby CBD. This is the first time the property has been offered to market in over 28 years.

**Type** : House

**View** : <https://www.fullerandco.com.au/8292523>

This beautiful home has just completed a full renovation throughout and provides low-maintenance carefree living. The property is set on a generous 568 sqm north facing block.

This is a fantastic opportunity to enter the highly sought-after Mullumbimby property market.

Features at a glance:



**Scot Fuller**  
02 5642 0177



**Charles Milburn**  
0412 257 057

[For full version visit the website](https://www.fullerandco.com.au)

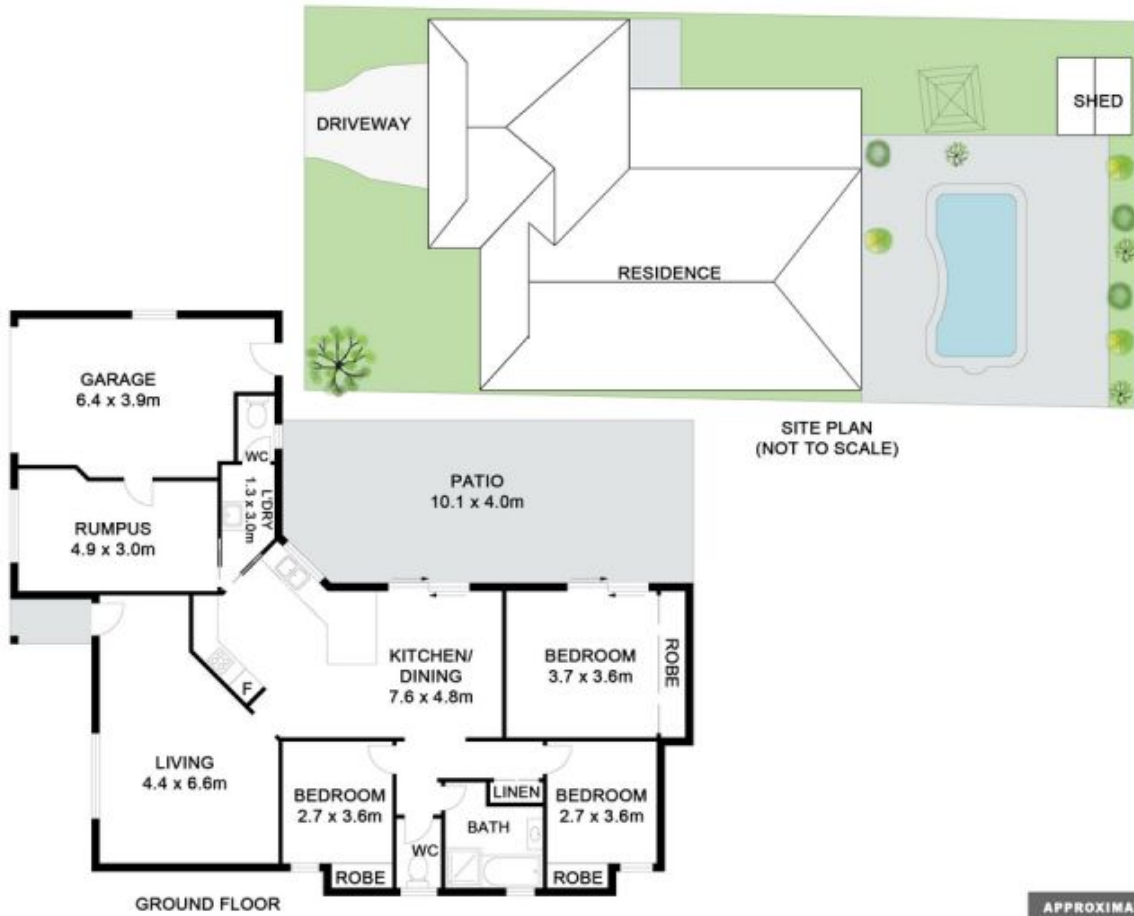

**3 BOTANIC COURT MULLUMBIMBY**

Floor Plan Disclaimer: See How Studios floor plans / site plans are intended as an approximate guide only. No representations or warranties of any nature are given or intended and any person using this information other than as a guide should always rely on their own enquiries. See How Studios property marketing services / Photography. Floor plans, Videos, Aerial photography / <https://seehowstudios.com.au>



APPROXIMATE AREAS	
INTERNAL FLOOR SPACE	- 134m <sup>2</sup>
EXTERNAL FLOOR SPACE	- 42m <sup>2</sup>
GARAGE	- 25m <sup>2</sup>