



## 443 Goonengerry Road Goonengerry NSW

5 🏠 2 🚗 2 🚗

Set on 15 lush acres with direct frontage to Wilsons Creek, this beautifully renovated hinterland retreat captures the essence of Northern Rivers living - privacy, nature, and effortless lifestyle all within minutes of Mullumbimby and a short drive to Byron Bay.

The home has been tastefully updated, blending modern comfort with its original country character. Set into the hillside, the residence enjoys a serene outlook across rolling cleared paddocks, established trees, and sparkling water views of the Wilsons River below. Sunlit interiors flow to multiple outdoor living and entertaining areas among the surrounding lush landscape.

[For full version visit the website](https://www.fullerandco.com.au)

**Type** : House  
**Price** : Contact Agent For Guide  
**Land Size** : 14.84 Acres  
**View** : <https://www.fullerandco.com.au/8543875>



**Scot Fuller**  
02 5642 0177



**Jesse Thompson**  
02 5642 0177



443 Goonengerry Road, Goonengerry  
5 bed | 2 bath | 2+ car

**Property size**

Internal	269m <sup>2</sup>
Car Space	52m <sup>2</sup>
Verandah	24m <sup>2</sup>
Patio	46m <sup>2</sup>
<b>Total</b>	<b>391m<sup>2</sup></b>

**Legend**

- 1. Residence
- 2. Shed
- 3. Lake

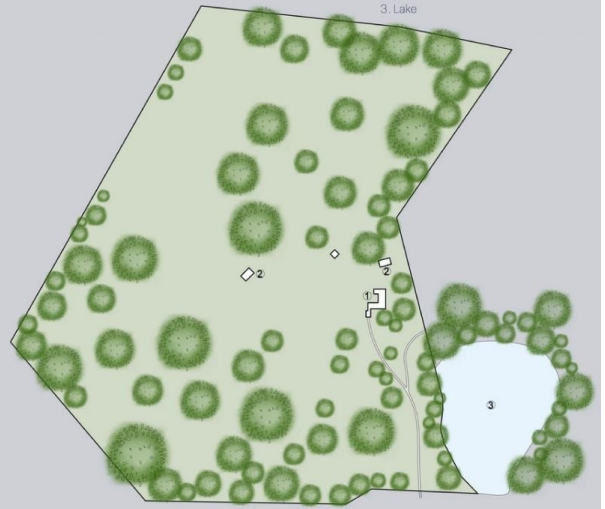

© Content of this publication is subject to copyright.  
The views expressed are not necessarily those of Fuller & Co or its agents.  
The information is correct and reliable as at the date of printing and may be subject to change without notice.  
Reproduction in whole or part of this publication is not permitted without written consent of Fuller & Co.

**FULLER**  
& co